

# e-SH/e-SHX Repair Parts

316SS END SUCTION CENTRIFUGAL PUMP (60 Hz)

### e-SH S-GROUP

Item No.	Part Description	Material	1x2-6	1½x2½-6	2x2½-6	2½x3-6	1x2-8	1½x2½-8	2x2½-8	1x2-10	Max. Wt. (lb)								
			01SH06	15SH06	02SH06	25SH06	01SH08	15SH08	02SH08	01SH10									
100	Casing with wear ring		1L450	1L453	1L924	1L459	1L451	1L454	1L457	1L452	17								
101	Impeller	AISI Type 316SS	6 <sup>1</sup> / <sub>16</sub>	2L978	6¾	2L876	6 <sup>9</sup> / <sub>16</sub>	2L945	7 <sup>5</sup> / <sub>32</sub>	2L961	8 <sup>3</sup> / <sub>16</sub>	2L972	8¼	2L879	8¼	2L985	9 <sup>41</sup> / <sub>64</sub>	2L965	7
			5 <sup>29</sup> / <sub>32</sub>	2L979	6 <sup>3</sup> / <sub>8</sub>	2L874	6 <sup>3</sup> / <sub>16</sub>	2L946	6 <sup>27</sup> / <sub>32</sub>	2L962	7 <sup>43</sup> / <sub>64</sub>	2L973	7 <sup>13</sup> / <sub>16</sub>	2L878	7¾	2L986	8 <sup>13</sup> / <sub>16</sub>	2L966	
			5 <sup>35</sup> / <sub>64</sub>	2L980	6 <sup>1</sup> / <sub>16</sub>	2L872	5 <sup>13</sup> / <sub>16</sub>	2L947	6½	2L983	7 <sup>21</sup> / <sub>64</sub>	2L974	7	2L877	7½	2L987	8 <sup>21</sup> / <sub>32</sub>	2L967	
			5 <sup>23</sup> / <sub>64</sub>	2L981	5 <sup>5</sup> / <sub>8</sub>	2L871	5½	2L948	6 <sup>19</sup> / <sub>64</sub>	2L963	7	2L975	6¾	2L876	7 <sup>3</sup> / <sub>16</sub>	2L988	8 <sup>3</sup> / <sub>16</sub>	2L968	
			4 <sup>61</sup> / <sub>64</sub>	2L982	5 <sup>5</sup> / <sub>16</sub>	2L870	5 <sup>1</sup> / <sub>8</sub>	2L949	5¾	2L984	6 <sup>11</sup> / <sub>16</sub>	2L976	6 <sup>7</sup> / <sub>16</sub>	2L875	6 <sup>7</sup> / <sub>8</sub>	2L989	8	2L969	
					4 <sup>11</sup> / <sub>16</sub>	2L869	4 <sup>13</sup> / <sub>16</sub>	2L950	5½	2L964	6¼	2L977	6 <sup>1</sup> / <sub>8</sub>	2L873	6 <sup>3</sup> / <sub>16</sub>	2L990	7¾	2L970	
					4 <sup>3</sup> / <sub>8</sub>	2L868	4 <sup>7</sup> / <sub>16</sub>	2L951									7 <sup>13</sup> / <sub>64</sub>	2L971	
103	Wear ring, casing		4L465	4L466	4L467	4L468	4L465	4L466	4L467	4L465	1								
184	Seal housing with ring		1L465		1L925	1L472	1L466		1L470	1L467	3								
203	Wear ring, seal housing		See Item 100			4L464	See Item 100												
126	Shaft sleeve	316SS	4L473	4L456			4L473	4L456		4L473									
178	Key, impeller	Steel		4K11			4K555	4K11		4K555	1								
422	Stud, impeller		13K217																
199	Washer, impeller	316SS	4L458																
108	Motor adapter, 143-184JM and S-group brg. frame	CI ASTM A48 CL 20	1L554	1L50			1L99	1L560	1L52	1L99	1L562	25							
	Motor adapter, 213-256JM		1L555	1L51			1L98	1L561	1L53	1L98	1L563	29							
370	Bolt, casing	300SS	13L38			13L89	13L38		13L89		-								
371 or 370B	Bolt, adapter, 143-184JM and S-Group brg. frame	Steel SAE 1200	13K360	13L43			13K360	13L43		13K360	25								
	Bolt, adapter, 213-256JM		13K379	13L41		13K245	13K361	13L40	13K245	13K361	29								
383	Mech. seal - standard	Type 21	10K27 - Carbon/Silicon-Carbide/Viton									1							
	Mech. seal - high temp.		10K19 - Carbon/Silicon-Carbide/EPR																
	Mech. seal - severe duty		10K64 - Silicon-Carbide/Silicon-Carbide/Viton																
383A	Retainer, seal spring	316SS	4K517																
408	Plug, vent and drain		6L60									2							
412A	O-ring, impeller washer	Viton	5K320 standard (5K195 EPR option)									1							
412F	O-ring, shaft sleeve		5K307 standard (5K306 EPR option)																
513	O-ring, casing - standard		5K407			5L70	5K408		5L70	5L71									
	O-ring, casing - optional	EPR	5K393			5K317	5K394		5K317	5L110									

### e-SH M-GROUP (254JM-365TCZ)

Item No.	Part Description	Material	1½x2½ -10		2x2½-10		2½x3-8		2½x3-10		3x4-8		3x4-10		Max. Wt. (lb)
			15SH10		02SH10		25SH08		25SH10		03SH08		03SH10		
100	Casing with wear ring		1L455		1L458		1L460		1L461		1L463		1L464		17
101	Impeller	AISI Type 316SS	9 <sup>7</sup> / <sub>8</sub>	2L778	9 <sup>7</sup> / <sub>8</sub>	2L790	9 <sup>1</sup> / <sub>16</sub>	2L952	10 <sup>3</sup> / <sub>8</sub>	2L804	9 <sup>1</sup> / <sub>16</sub>	2L825	10 <sup>5</sup> / <sub>8</sub>	2L836	8
			9½	2L779	9½	2L791	8¾	2L953	9 <sup>15</sup> / <sub>16</sub>	2L805	8 <sup>11</sup> / <sub>16</sub>	2L826	10¼	2L837	
			9 <sup>3</sup> / <sub>16</sub>	2L780	9 <sup>1</sup> / <sub>8</sub>	2L792	8½	2L954	9 <sup>9</sup> / <sub>16</sub>	2L806	8 <sup>7</sup> / <sub>16</sub>	2L827	9 <sup>13</sup> / <sub>16</sub>	2L838	
			8 <sup>7</sup> / <sub>8</sub>	2L781	8 <sup>13</sup> / <sub>16</sub>	2L793	8¼	2L955	9¼	2L807	8 <sup>1</sup> / <sub>16</sub>	2L828	9 <sup>7</sup> / <sub>16</sub>	2L839	
			8 <sup>9</sup> / <sub>16</sub>	2L782	8 <sup>3</sup> / <sub>16</sub>	2L794	7 <sup>7</sup> / <sub>8</sub>	2L956	8¾	2L809	7 <sup>11</sup> / <sub>16</sub>	2L829	9 <sup>1</sup> / <sub>16</sub>	2L825	
			8¼	2L783	7 <sup>15</sup> / <sub>16</sub>	2L795	7½	2L957			7½	2L830	8 <sup>11</sup> / <sub>16</sub>	2L826	
					7 <sup>11</sup> / <sub>16</sub>	2L796	7 <sup>1</sup> / <sub>8</sub>	2L958			7 <sup>1</sup> / <sub>8</sub>	2L831			
							6 <sup>11</sup> / <sub>16</sub>	2L959			6 <sup>7</sup> / <sub>8</sub>	2L832			
							6½	2L960			6½	2L833			
											6	2L834			
								5½	2L835						
103	Wear ring, casing		4L467			4L468			4L469			1			
184	Seal housing with ring		1L468			1L473		1L475			1L478		3		
203	Wear ring, seal housing		4L201			4L464									
126	Shaft sleeve	316SS	4L457												1
178	Key, impeller	Steel	4K261												
422	Stud, impeller		13K301												
199	Washer, impeller	316SS	4L463												
108	Motor adapter, 254-256JM and M-group bearing frame	CI ASTM A48 CL 20	1L91			1L89			1L93			1L94			31
	Motor adapter, 280JM-365TCZ		1L90			1L88			1L92			1L95			44
370	Bolt, casing	300SS	13L86 (6 req'd)			13L89 (8 req'd)			13L86 (8 req'd)			13K45 (8 req'd)			-
371 or 370B	Bolt, adapter, 254-256JM and S-Group bearing frame	Steel SAE 1200	13L88					13L116					-		
	Bolt, adapter, 280JM-365TCZ		13L87					13L115					-		
383	Mech. seal - standard	Type 21	10K45 - carbon/silicon-carbide/viton												1
	Mech. seal - high temp.		10K20 - Carbon/silicon-carbide/EPR												
	Mech. seal - severe duty		10K65 - Silicon-carbide/silicon-carbide/viton												
383A	Retainer, seal spring	316SS	4K500												2
408	Plug, vent and drain		6L60												
412A	O-ring, impeller washer	Viton	5K309 standard (5K308 EPR option)												1
412F	O-ring, shaft sleeve		5K309 standard (5K308 EPR option)												
513	O-ring, casing - standard		5L71			5L70			5L71			5L72			
	O-ring, casing - optional	EPR	5L110			5K317			5L110			5L116			

### e-SH M-GROUP (140JM, 180JM & 210JM)

Item No.	Part Description	Material	1½x2½-10		2x2½-10		2½x3-8		2½x3-10		3x4-8		Max. Wt. (lb)
			15SH10		02SH10		25SH08		25SH10		03SH08		
100	Casing with wear ring	AISI Type 316SS	1L455		1L458		1L460		1L461		1L463		17
101	Impeller		9 <sup>7</sup> / <sub>8</sub>	2L784	9 <sup>7</sup> / <sub>8</sub>	2L797	9 <sup>1</sup> / <sub>16</sub>	2L991	9 <sup>15</sup> / <sub>16</sub>	2L817	9 <sup>1</sup> / <sub>16</sub>	2L840	8
			9 <sup>1</sup> / <sub>2</sub>	2L785	9 <sup>1</sup> / <sub>2</sub>	2L798	8 <sup>1</sup> / <sub>2</sub>	2L992	9 <sup>9</sup> / <sub>16</sub>	2L818	8 <sup>7</sup> / <sub>16</sub>	2L841	
			9 <sup>3</sup> / <sub>16</sub>	2L786	9 <sup>1</sup> / <sub>8</sub>	2L799	8 <sup>1</sup> / <sub>4</sub>	2L993	9 <sup>1</sup> / <sub>4</sub>	2L819	8 <sup>1</sup> / <sub>16</sub>	2L842	
			8 <sup>7</sup> / <sub>8</sub>	2L787	8 <sup>13</sup> / <sub>16</sub>	2L800	7 <sup>7</sup> / <sub>8</sub>	2L994	8 <sup>3</sup> / <sub>4</sub>	2L821	7 <sup>11</sup> / <sub>16</sub>	2L843	
			8 <sup>9</sup> / <sub>16</sub>	2L788	8 <sup>3</sup> / <sub>16</sub>	2L801	7 <sup>1</sup> / <sub>8</sub>	2L995			7 <sup>1</sup> / <sub>8</sub>	2L844	
			8 <sup>1</sup> / <sub>4</sub>	2L789	7 <sup>15</sup> / <sub>16</sub>	2L802	6 <sup>11</sup> / <sub>16</sub>	2L996			6 <sup>1</sup> / <sub>2</sub>	2L845	
					7 <sup>11</sup> / <sub>16</sub>	2L803					6	2L846	
											5 <sup>1</sup> / <sub>2</sub>	2L847	
103	Wear ring, casing			4L467			4L468			4L469			1
184	Seal housing with ring		1L468			1L473		1L474				3	
203	Wear ring, seal housing		4L201			4L464							
126	Shaft sleeve	316SS	4K501			4L456							
178	Key, impeller	Steel	4K11										1
422	Stud, impeller		13K217										
199	Washer, impeller	316SS	4L458										
108	Motor adapter, 143-184JM and S-group bearing frame	CI ASTM A48 CL 20	1L97			1L99		1L123					25
	Motor adapter, 213		1L96			1L98		1L100					29
370	Bolt, casing	300SS	13L86 (6 req'd)			13L89 (8 req'd)		13L86 (8 req'd)					-
371 or 370B	Bolt, adapter, 143-184JM and S-Group bearing frame	Steel SAE 1200	13L43					N/A		13L117			-
	Bolt, adapter, 213-256JM		13K245					13K44			-		
383	Mech. seal - standard	Type 21	10K27										1
	Mech. seal - high temp.		10K19										
	Mech. seal - severe duty		10K64										
383A	Retainer, seal spring	316SS	4K517										
408	Plug, vent and drain		6L60										2
412A	O-ring, impeller washer	Viton	5K320 standard (5K195 EPR option)										1
412F	O-ring, shaft sleeve		5K320 standard (5K195 EPR)				5K307 (5K306 EPR option)						
513	O-ring, casing - standard		5L71		5L70		5L71						
	O-ring, casing - optional	EPR	5L110		5K317		5L110						

### e-SHX M-GROUP (254JM-256JM)

Item No.	Part Description	Material	1½x2½-10		2x2½-10		2½x3-8		3x4-8		Max. Wt. (lb)	
			15SH10		02SH10		25SH08		03SH08			
100	Casing with wear ring	AISI Type 316SS	Refer Page - 3		Refer Page - 3		Refer Page - 3		Refer Page - 3		17	
101	Impeller		8 3/4	2L1035	8	2L1049	6 1/2	2L960	6	2L834	8	
103	Wear ring, casing		Refer Page - 3		Refer Page - 3		Refer Page - 3		Refer Page - 3		1	
184	Seal housing with ring		Refer Page - 3		Refer Page - 3		Refer Page - 3		Refer Page - 3		3	
203	Wear ring, seal housing		Refer Page - 3		Refer Page - 3		Refer Page - 3		Refer Page - 3		1	
126	Shaft sleeve		316SS	Refer Page - 3								
178	Key, impeller	Steel	Refer Page - 3									
422	Stud, impeller		Refer Page - 3									
199	Washer, impeller	316SS	Refer Page - 3									
108	Motor adapter, 254-256JM	CI ASTM A48 CL 20	Refer Page - 3			Refer Page - 3		Refer Page - 3		31		
370	Bolt, casing	300SS	Refer Page - 3			Refer Page - 3		Refer Page - 3		-		
371	Bolt, adapter, 254-256JM	Steel SAE 1200	Refer Page - 3					Refer Page - 3		-		
383	Mech. seal - standard	Type 21	Refer Page - 3									1
	Mech. seal - high temp.		Refer Page - 3									
	Mech. seal - severe duty		Refer Page - 3									
383A	Retainer, seal spring	316SS	Refer Page - 3									2
408	Plug, vent and drain		Refer Page - 3									
412A	O-ring, impeller washer	Viton	Refer Page - 3									1
412F	O-ring, shaft sleeve		Refer Page - 3									
513	O-ring, casing - standard		Refer Page - 3			Refer Page - 3		Refer Page - 3		Refer Page - 3		
	O-ring, casing - optional	EPR	Refer Page - 3			Refer Page - 3		Refer Page - 3		Refer Page - 3		

### e-SH Exploded View

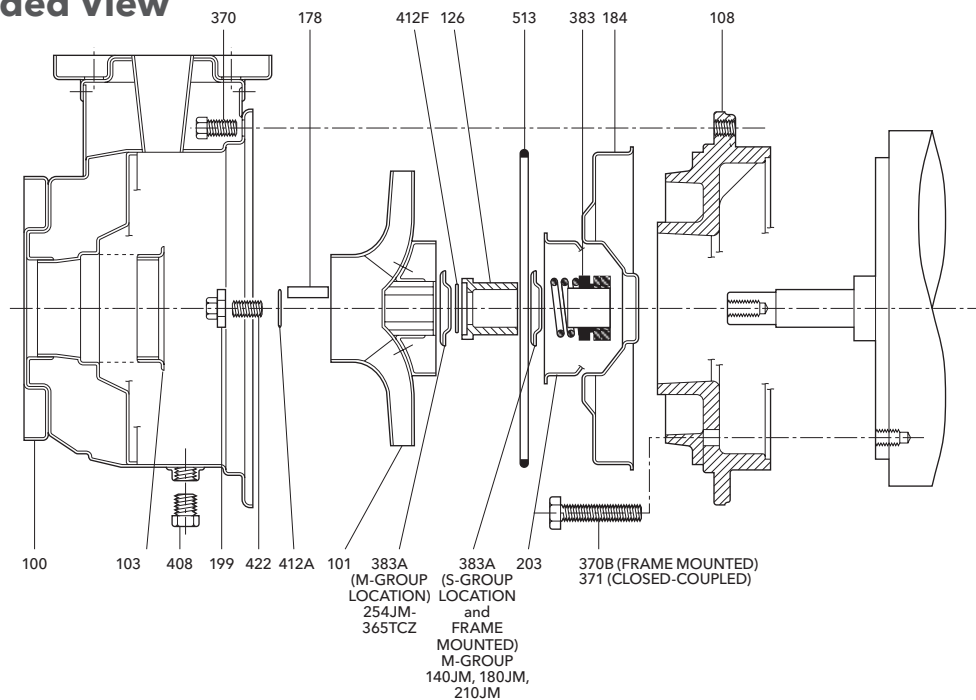

### e-SHX S-GROUP

Item No.	Part Description	Material	1x2-6		1½x2½-6		2x2½-6		2½x3-6		1x2-8		1½x2½-8		2x2½-8		1x2-10		Max. Wt. (lb)	
			01SH06		15SH06		02SH06		25SH06		01SH08		15SH08		02SH08		01SH10			
100	Casing with wear ring	AISI Type 316SS	Refer Page - 2		Refer Page - 2		Refer Page - 2		Refer Page - 2		Refer Page - 2		Refer Page - 2		Refer Page - 2		Refer Page - 2		17	
101	Impeller		5 1/2	2L1011	6 1/2	2L1024	6 3/16	2L946	6 1/2	2L983	7 3/4	2L1004	7 3/4	2L1020	8	2L1016	8 3/4	2L1000	7	
			-	-	5	2L1029	5 1/8	2L949	5 1/2	2L964	6 1/4	2L1007	6 1/4	2L1025	-	-	-	-		
103	Wear ring, casing		Refer Page - 2	Refer Page - 2		Refer Page - 2		Refer Page - 2		Refer Page - 2		Refer Page - 2		Refer Page - 2		Refer Page - 2		Refer Page - 2		1
184	Seal housing with ring		Refer Page - 2			Refer Page - 2		Refer Page - 2		Refer Page - 2		Refer Page - 2			Refer Page - 2		Refer Page - 2		3	
203	Wear ring, seal housing		See Item 100						Refer Page - 2		See Item 100									
126	Shaft sleeve	316SS	Refer Page - 2		Refer Page - 2				Refer Page - 2		Refer Page - 2				Refer Page - 2					
178	Key, impeller	Steel	Refer Page - 2		Refer Page - 2				Refer Page - 2		Refer Page - 2				Refer Page - 2		1			
422	Stud, impeller		Refer Page - 2																	
199	Washer, impeller	316SS	Refer Page - 2																	
108	Motor adapter, 143-184JM	Cl ASTM A48 CL 20	Refer Page - 2		Refer Page - 2														25	
	Motor adapter, 213-256JM		Refer Page - 2				Refer Page - 2		Refer Page - 2		Refer Page - 2		Refer Page - 2		Refer Page - 2		Refer Page - 2		29	
370	Bolt, casing	300SS	Refer Page - 2				Refer Page - 2		Refer Page - 2				Refer Page - 2				-			
371	Bolt, adapter, 143-184JM	Steel SAE 1200	Refer Page - 2		Refer Page - 2														25	
	Bolt, adapter, 213-256JM		Refer Page - 2				Refer Page - 2		Refer Page - 2		Refer Page - 2		Refer Page - 2		Refer Page - 2		Refer Page - 2		29	
383	Mech. seal - standard	Type 21	Refer Page - 2																	1
	Mech. seal - high temp.		Refer Page - 2																	
	Mech. seal - severe duty		Refer Page - 2																	
383A	Retainer, seal spring	316SS	Refer Page - 2																	
408	Plug, vent and drain		Refer Page - 2																	2
412A	O-ring, impeller washer	Viton	Refer Page - 2																	1
412F	O-ring, shaft sleeve		Refer Page - 2																	
513	O-ring, casing - standard		Refer Page - 2				Refer Page - 2		Refer Page - 2				Refer Page - 2		Refer Page - 2					
	O-ring, casing - optional	EPR	Refer Page - 2				Refer Page - 2		Refer Page - 2				Refer Page - 2		Refer Page - 2					

### e-SHX Conversion Kits

Current e-SH Configuration					e-SHX Conversion Kit		
Model	Cast		Fabricated		Model	Kit P/N	As Needed
	Imp Trim	Imp ø	Imp Trim	Imp ø			Motor Adapter
01SH06	F	6 1/16	A	6 1/16	01SHX06H	01SHX06HKIT	1L554
	G	5 3/4	B	5 29/32			
	H	5 1/2	C	5 35/64			
	I	5 1/4	D	5 23/64			
	J	5	----	----			
	K	4 3/4	----	----			
01SH08	G	8 3/16	A	8 3/16	01SHX08H	01SHX08HKIT	1L561
	H	7 3/4	B	7 43/64			
	J	7 1/4	C	7 21/64			
	K	6 3/4	D	7	01SHX08L	01SHX08LKIT	
	L	6 1/4	E	6 11/16			
	M	5 3/4	F	6 1/4			
01SH10	K	8 3/4	B	8 13/16	01SHX10M	01SHX10MKIT	1L563
	L	8 3/8	C	8 21/32			
	M	8	D	8 3/16			
	----	----	E	8			
	----	----	F	7 3/4			
	----	----	G	7 13/64			
15SH06	J	7	A	6 3/4	15SHX06K	15SHX06KKIT	1L51
	K	6 1/2	B	6 3/8			
	L	6	C	6 1/16			
	----	----	D	5 5/8	15SHX06N	15SHX06NKIT	1L50
	M	5 1/2	E	5 5/16			
	N	5	F	4 11/16			
P	4 1/2	G	4 3/8				
15SH08	H	7 3/4	A	8 1/4	15SHX08J	15SH08JKIT	1L53
	J	7 3/16	B	7 13/16			
	K	6 3/4	C	7			
	L	6 1/4	D	6 3/4	15SHX08L	15SH08LKIT	
	M	5 3/4	E	6 7/16			
	----	----	F	6 1/8			
15SH10	H	9 1/2	B	9 1/2	15SHX10K	15SH10KKIT	1L91
	J	9 1/8	C	9 3/16			
	K	8 3/4	D	8 7/8			
	L	8 3/8	E	8 9/16			
	M	8	F	8 1/4			
	N	7 5/8	----	----			
02SH06	A	6 9/16	----	----	02SHX06C	02SH06CKIT	1L51
	B	6 3/16					
	C	5 13/16					
	D	5 1/2					
	E	5 1/8					
	F	4 13/16					
02SH08	K	6 3/4	E	6 7/8	02SHX08L	02SH08LKIT	1L98
	L	6 1/4	F	6 3/16			

(continued on next page)

## e-SHX Conversion Kits (continued)

Current e-SH Configuration					e-SHX Conversion Kit		
Model	Cast		Fabricated		Model	Kit P/N	As Needed
	Imp Trim	Imp ø	Imp Trim	Imp ø			Motor Adapter
02SH10	L	8 3/4	D	8 13/16	02SHX10N	02SH10NKIT	1L91
	M	8 3/8	E	8 3/16			
	N	8	F	7 15/16			
	----	----	G	7 11/16			
25SH06	E	5 3/4	----	----	25SHX06F	25SH06FKIT	1L98
	F	5 1/2					
25SH08	G	7 1/8	----	----	25SHX08J	25SH08JKIT	1L89
	H	6 11/16					
	J	6 1/2					
03SH08	J	6 1/2	----	----	03SHX08K	03SH08KKIT	1L93
	K	6					
	L	5 1/2					

## e-SHX Motor/Drive Table

Motor/Drive Repair Parts			
Model	Motor + Drive (1)	Motor Only (2)	Drive Only (3)
01SHX06H7H42	100637850	KL60AF0	KL55ANA
15SHX06N0542	100637810	KL60AH7	
01SHX08H1542	100638010	KL60AKS	KL55ANC
01SHX08L1042	100637970	KL60AKQ	
01SHX10M1542	100638010	KL60AKS	
15SHX06K1542	100638010	KL60AKS	
15SHX08J1542	100638010	KL60AKS	
15SHX08L1542	100638010	KL60AKS	
02SHX06C1542	100638010	KL60AKS	
02SHX06E1542	100638010	KL60AKS	
02SHX08L1542	100638010	KL60AKS	
25SHX06F1542	100638010	KL60AKS	
15SHX10K3042	100638210	KL60AK3	KL55ANE
02SHX10N3042	100638210	KL60AK3	
25SHX08J3042	100638210	KL60AK3	
03SHX08K3042	100638210	KL60AK3	

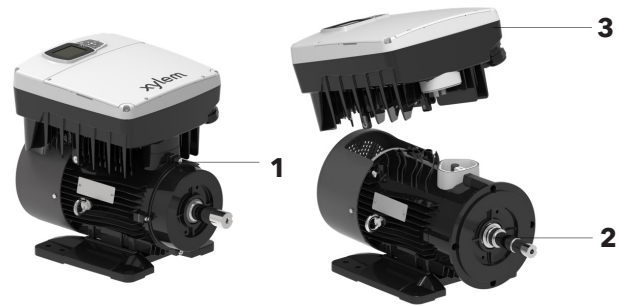

**xylem**  
Let's Solve Water

Xylem Inc.  
Phone: (866) 673-0428  
Fax: (888) 322-5877  
www.xylem.com/goulds

Xylem is a registered trademark of Xylem Inc. or one of its subsidiaries. Goulds is a registered trademark of ITT Manufacturing Enterprises LLC and is used under license. All other trademarks or registered trademarks are property of their respective owners.  
© 2024 Xylem Inc. ReSHSMGR R3 February 2024

Learn more about  
e-SHX Smart Pumps

